

Processing instructions V1-Attachment Vigano® Telescopic technology

Working on the patrices

1. Align the master model at a right angle to the course of the jaw ridge for establishing the direction for insertion.

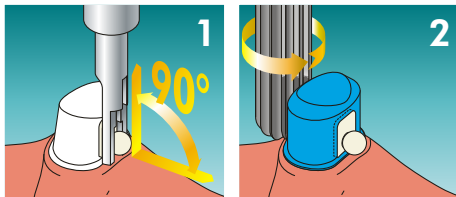

2. Form the crown from wax as accustomed. Use a parallel holder to bring the patrix (POM) close to the stub, attach it with the back plate to the crown near the base and integrate it into the model. The ball on the basal side can be flattened off by up to one-third without any loss of friction in order to get as close as possible to the jaw ridge.

Do preliminary grinding on the surface of the primary crown which is situated opposite the patrix parallel to the back plate of the patrix.

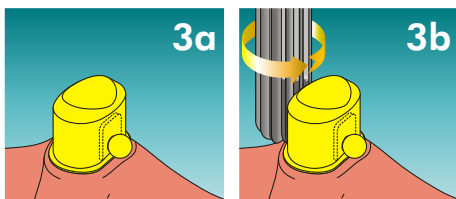

3. Embed the primary part of the crown model and cast it as accustomed. In doing so, pay attention by all means that the insertion surface and the ball are free of wax residue. Proceed with embossing as usual; do not work on the primary section. Do subsequent grinding on the side of the primary crown facing the patrix.

Working on the matrixes

4. Place the matrix onto the patrix and fill the hollow space beneath the base plate up to the jaw ridge and the undercut beneath the t-plate with wax. Duplicate the model.

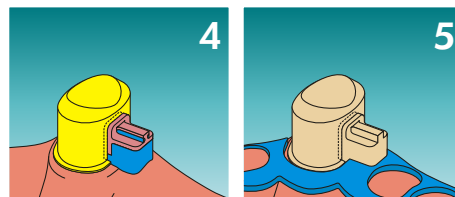

5. Create the model casting base as accustomed, omitting the area of the attachment.

6. Place the matrix onto the patrix and wax off the matrix on the side. Attach the model casting base and use prosthesis adhesive to affix it with the matrix. Finish as usual.

The matrix is held in the prosthesis plastic mechanically.

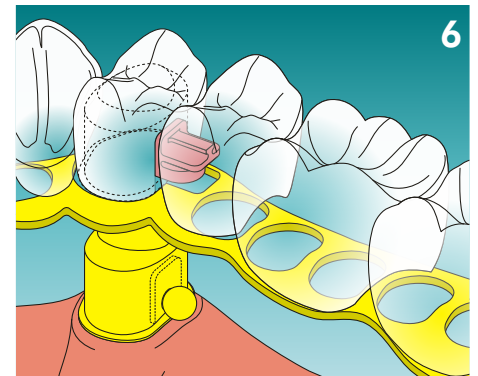

Procedures for Repair and/or Preparation of a new Casting pattern

7. Fit the seating tool into the denture's matrix.

Wax it lightly at the basal side and prepare the master model in the usual way.

Remove the used matrix and replace it by a new one, or prepare a new casting pattern with the new matrix.

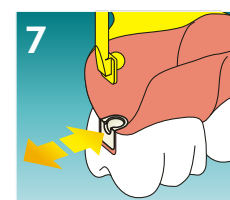

vigano[®]
DENTAL

Clemensstraße 14
D 44 789 Bochum
fon: 02 34-30 17 84
fax: 02 34-33 05 45
web: www.vigano-dental.de
email: info@vigano-dental.de